

LEGENDA ELÉTRICA	
S	INTERRUPTOR
2x40 4	PONTO DE LUZ FLUORESCENTE
60	PONTO DE LUZ INCANDESCENTE
	TOMADA
TEL.	PLUG P/ TELEFONE
INT.	PLUG P/ INTERFONE
	QUADRO DE DISTRIBUIÇÃO
T.V	PLUG P/ TV

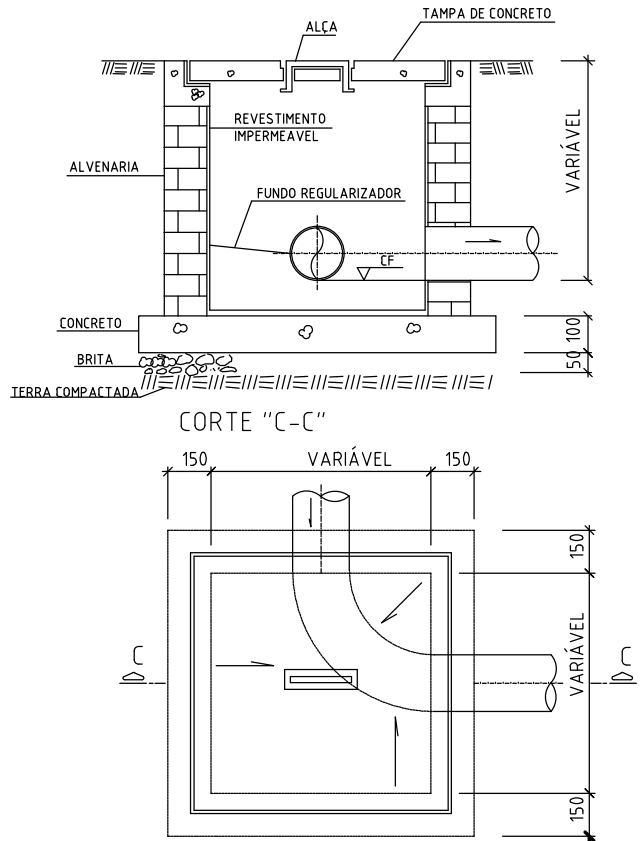

PLANTA
DET. CAIXA DE INSPEÇÃO DE ESGOTO (CIES)
S/ ESC.

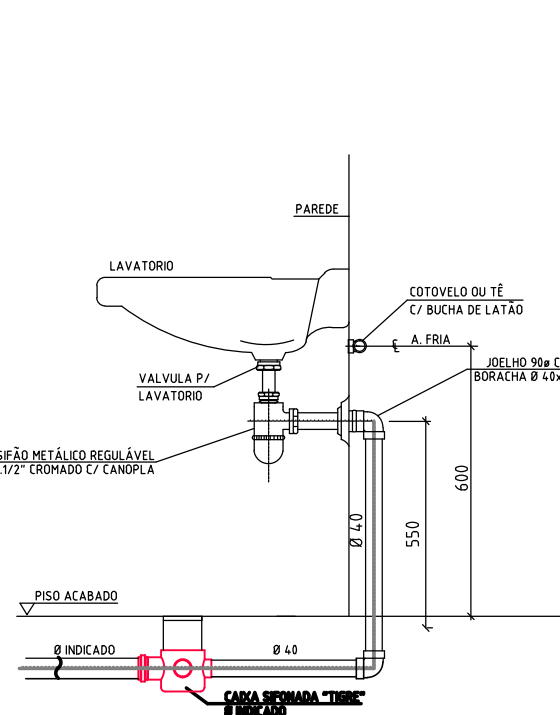

DET. LIGAÇÃO DE LAVATÓRIO
S/ESC.

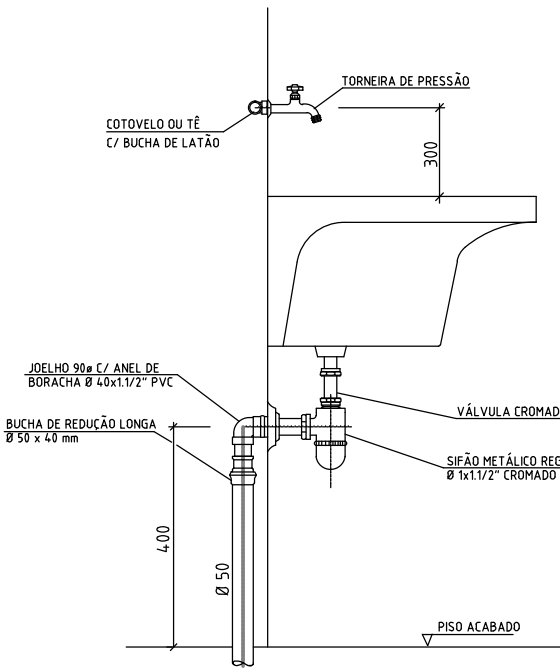

DET. LIGAÇÃO DE TANQUE
S/ESC.

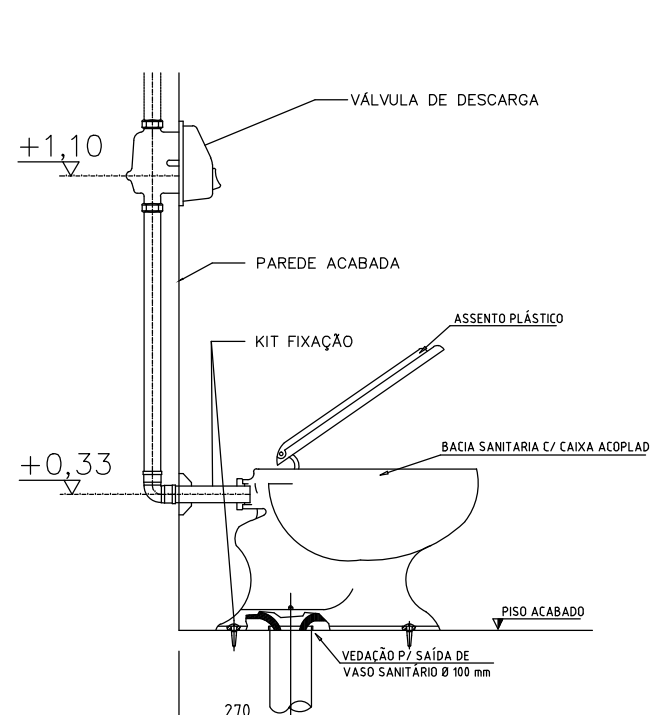

DET. BACIA SANITÁRIA
S/ESC.

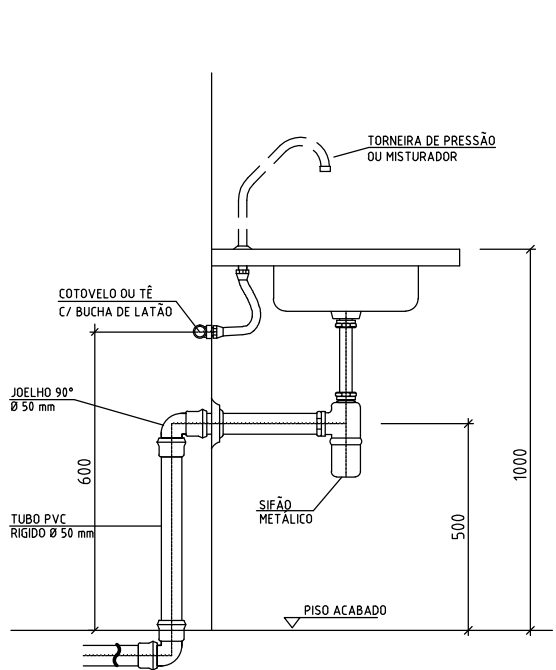

DET. LIGAÇÃO DE PIA
S/ESC.

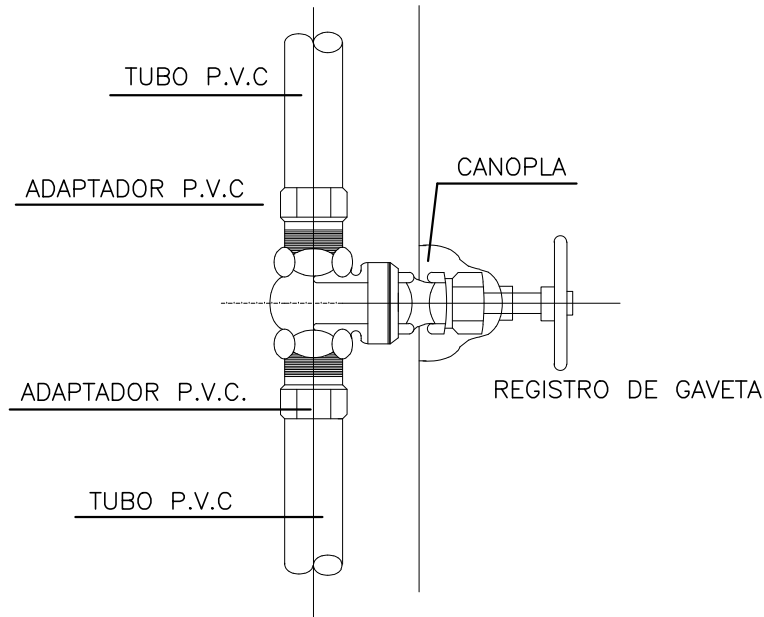

DET. REGISTRO DE GAVETA
S/ESC.

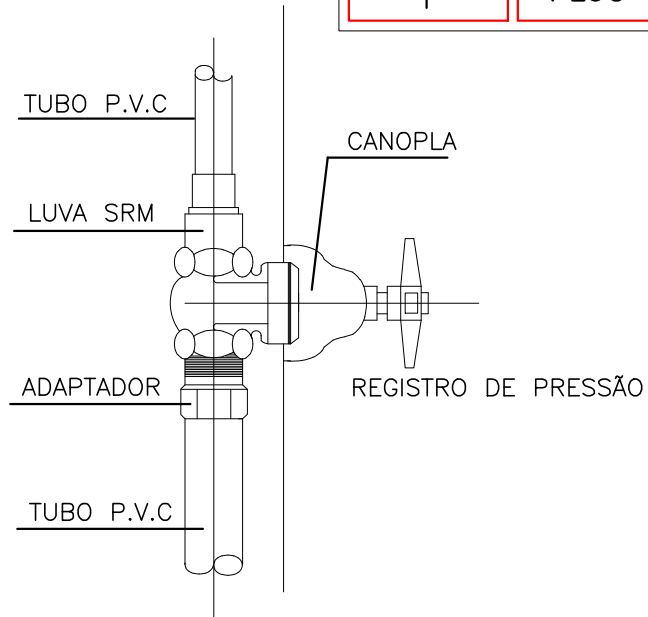

DET. REGISTRO DE PRESSÃO
S/ESC.

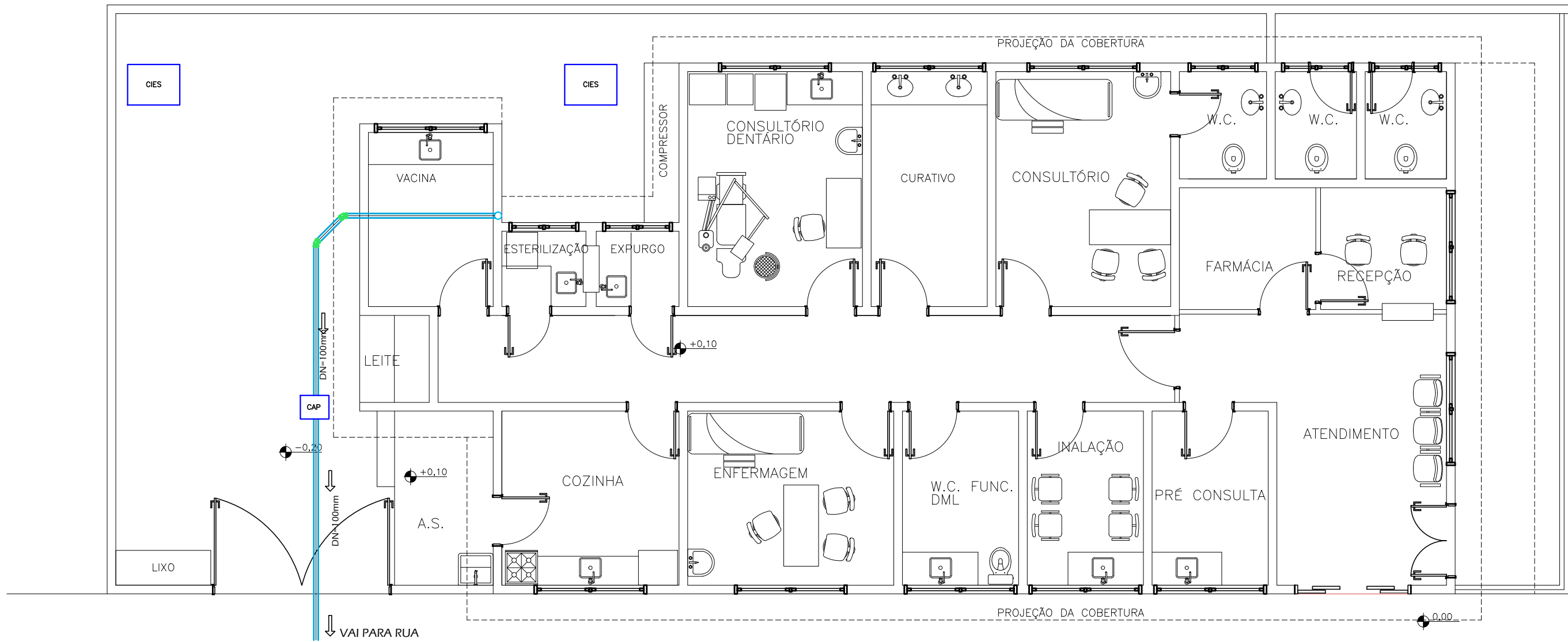

HIDRÁULICA AGUAS PLUVIAIS
ESC.: 1:75

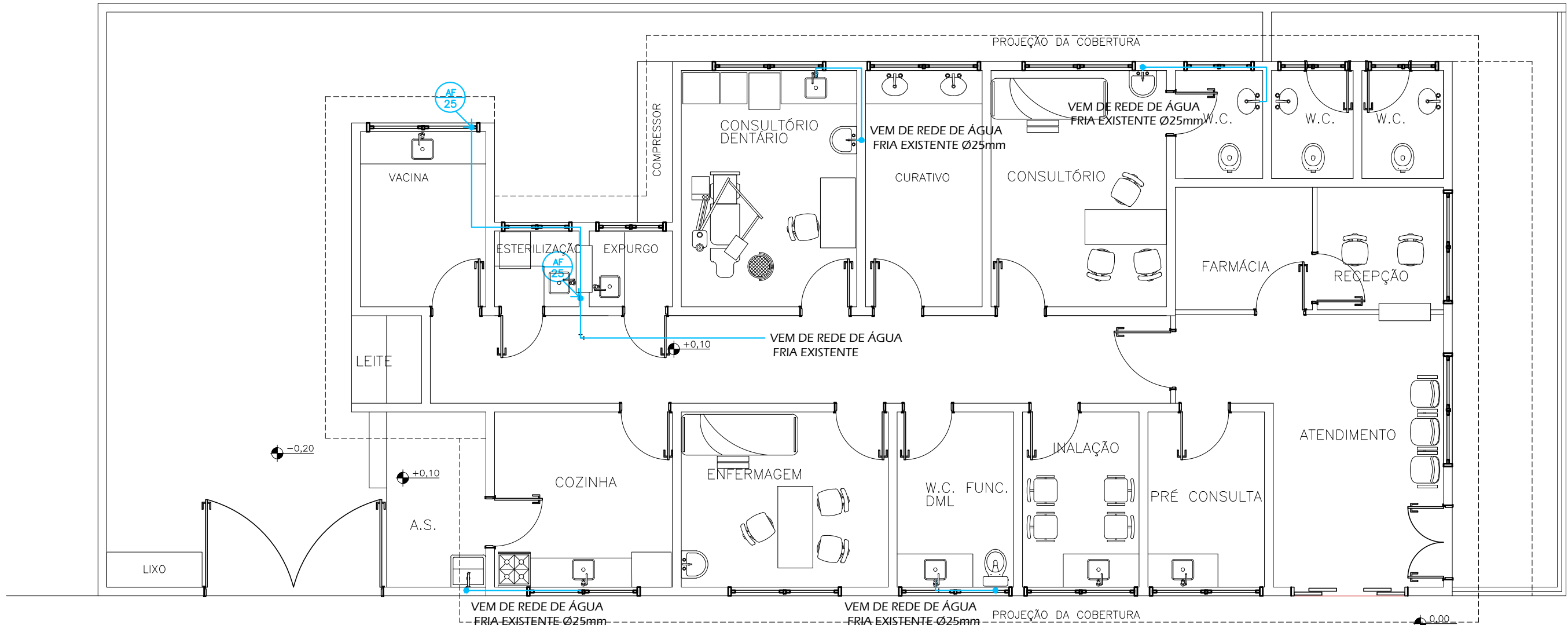

HIDRÁULICA AGUA FRIA
ESC.: 1:75

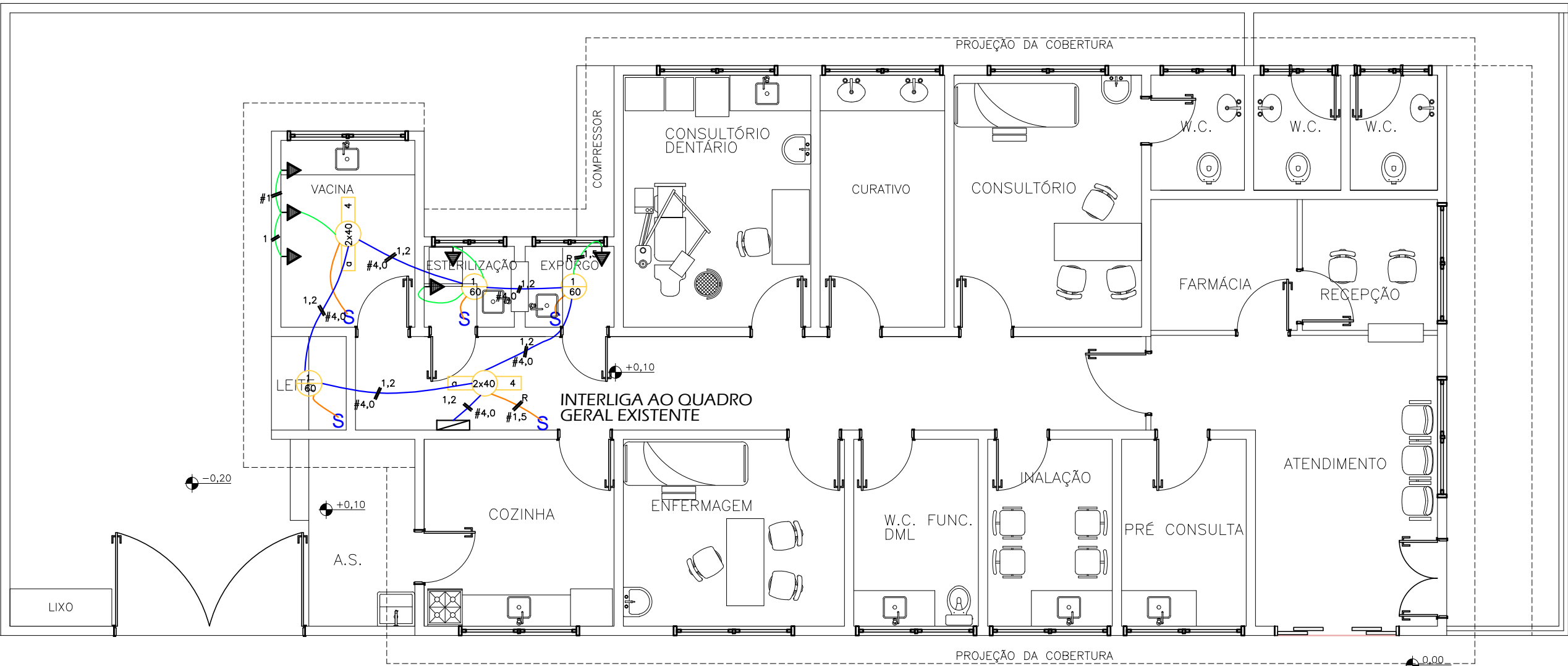

ELETRICA CIRCUITOS
ESC.: 1:75

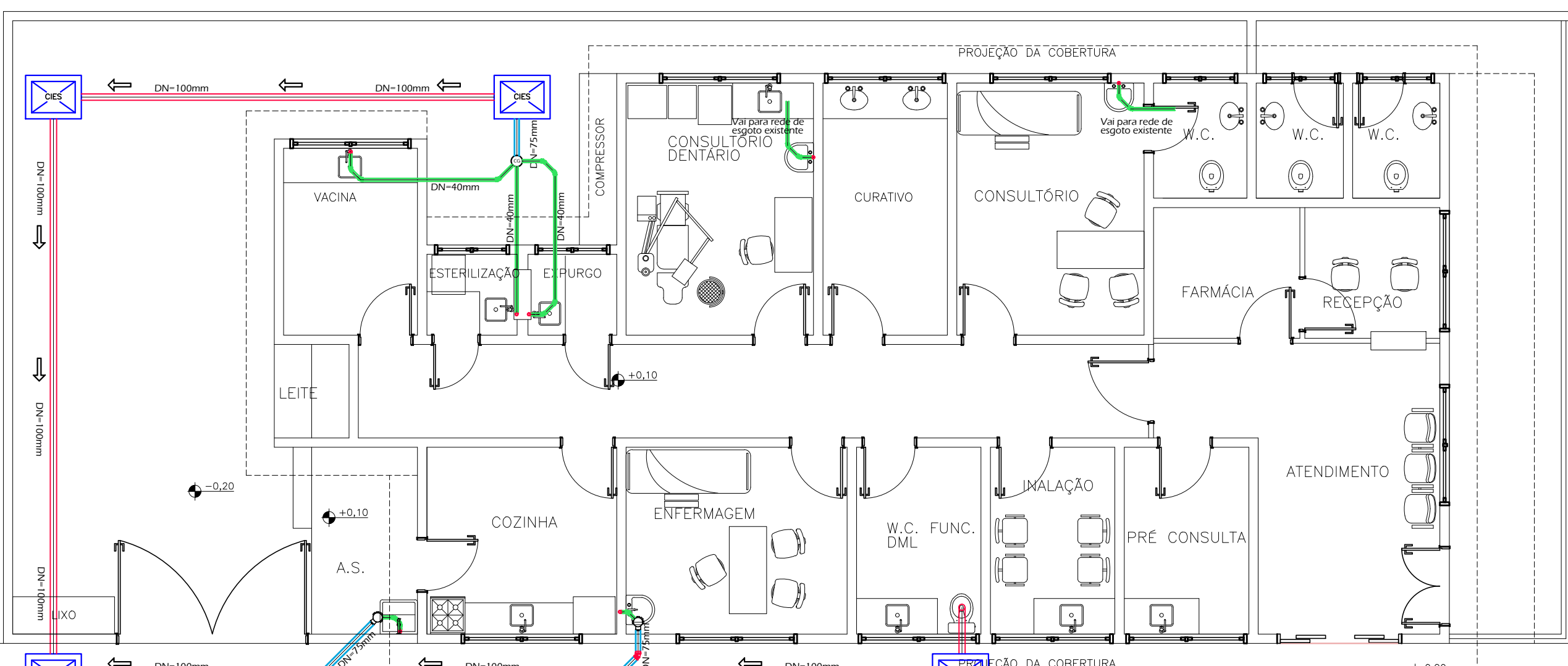

HIDRÁULICA ESGOTO
ESC.: 1:75

LEGENDA HIDRÁULICA	
AF - tubo de PVC - 32mm	
AC - alumínio - 20mm	
ESG - tubo de PVC - 40mm	
ESG - tubo de PVC - 75mm	
ESG - tubo de PVC - 100mm	



Rua Campos Sales,196 - Batatinha-SP Fone/Fax: 3527-1897 e-mail: anj.lucasello@terra.com.br

U.S.F. CONCEIÇÃO THIBES DO CANTO

CLIENTE:
PREFEITURA MUNICIPAL DE ITAPETININGA
LOCAL:
RUA MARIA ROCHA MACHADO S/Nº
BAIRRO TUPY - ITAPETININGA-SP
ÁREA:
Total - 154,94m2 Intervenção - 12,13m2
Terreno-255,48m2

ASSUNTO FOLHA

HIDRÁULICA/ELÉTRICA

JAN/2014

1:75

direitos autorais reservados

F.U.